

## INSPECTION

### 1. INSPECT GARAGE DOOR OPENER

Press the switch and check that each LED (red) lights up. Even if only one switch is found not to light up, replace it.

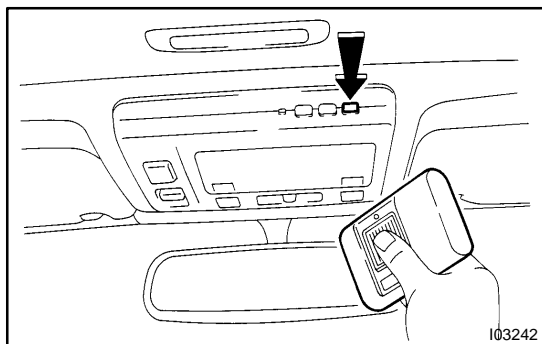

### 2. INSPECT GARAGE DOOR OPENER REGISTRATION AND TRANSMITTING

#### HINT:

Use the home link tester made by KENT MORE for this test. As it is necessary to record the code of the hand held transmitter, customer's code will be erased. When the inspection completes, please register the customer's again.

- (a) Check that the code of hand held transmitter for inspection can be recorded.

(See page

If the code can not be registered, replace garage door opener.

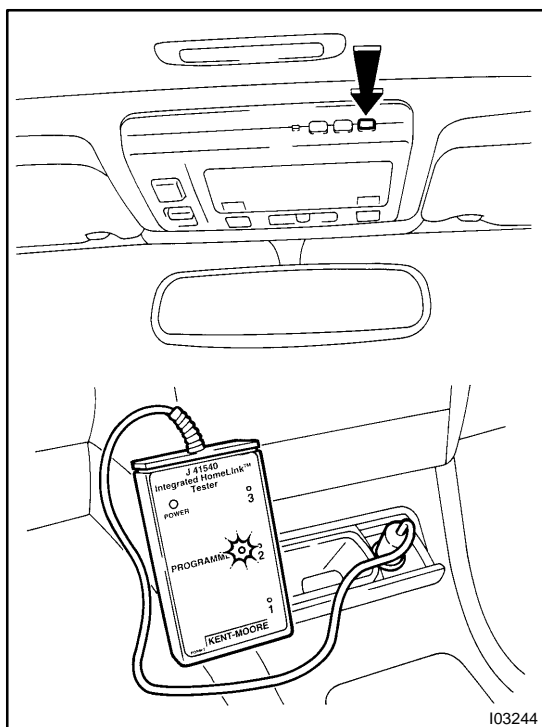

- (b) Press the switch which an inspection code has been registered for and check that LED (green) of the home link tester lights up.

If the LED (green) does not light up, replace the garage door opener.

Wire Harness Side

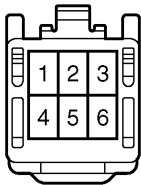

I03432

3. INSPECT GARAGE DOOR OPENER CIRCUIT

Disconnect the connector from the switch and inspect the connector on the wire harness side, as shown.

Tester connection	Condition	Specified condition
5 – Ground	Constant	Continuity
4 – Ground	Constant	Battery positive voltage